



# LITHIUM BATTERY

## ER14250

1/2AA size bobbin cell (energy type)

### Technical Datasheet

#### The ABLE Advantage

Better technology. Our batteries enable us to design leading-edge solutions for the world's most demanding applications.



#### SPECIFICATIONS

Part No	ER14250
Alternative models	LS14250/LST14250/LS14250C/TL4902/SB-AA02/SB-AA02P
Voltage Range	2.0 to 3.7 V
Nominal Voltage	3.6 V
Nominal Capacity	1200 mAh @ 0.5mA to 2.0 V @ 20° C
Max. Discharge	50 mA continuous
Pulse Capability	Up to 100 mA Varies according to pulse characteristics, temperature, cell history and the application. Consult ABLE.
Typical Weight	10 grams
Operating Temp	-55° C to 85° C
Storage Temp	30° C MAX(recommended)
Exterior/Housing	stainless steel
Terminals/Connector	radial tabs/ radial pins/axial leads/flying leads
Safety	Material Safety Datasheet – MSDS.
Transportation	Excepted from Regulations – see note 1

#### FEATURES

- High and stable operating voltage
- Superior drain capability
- Low self-discharge rate  
(less than 2% after 1year of storage at 20°C)
- Hermetic glass-to-metal sealing
- Non-flammable electrolyte

#### APPLICATIONS

- Radio communication and other military applications
- Alarms and security systems
- Transmitters
- GPS
- LED lighting applications
- Others

<b>Note 1</b>	For a complete description of transportation regulations and definitions of the transportation classifications "Excepted" and "Class 9," refer to the Ultralife web site at <a href="http://www.ultralifecorporation.com">www.ultralifecorporation.com</a> .
---------------	--------------------------------------------------------------------------------------------------------------------------------------------------------------------------------------------------------------------------------------------------------------

**DIMENSIONS**

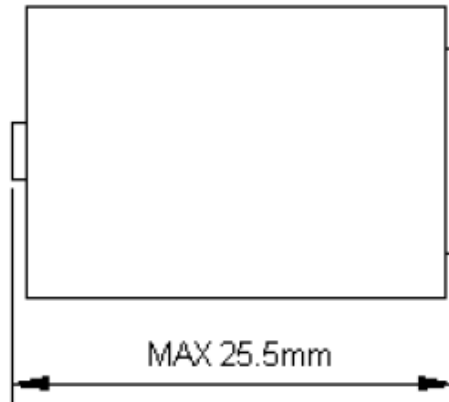
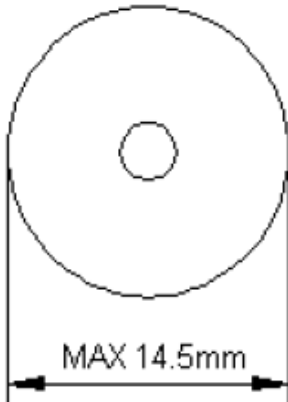

**PERFORMANCE GRAPHS**

Discharge performance(RT)

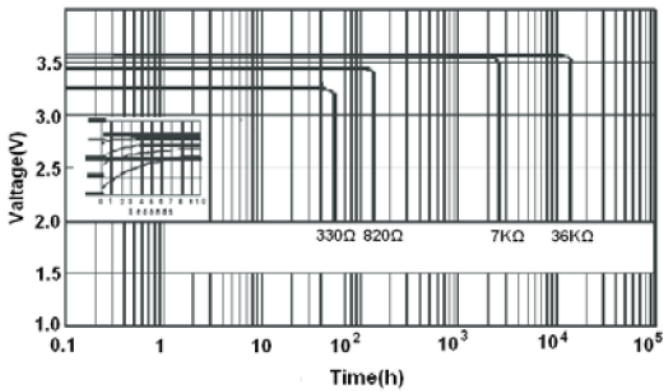

Capacity VS Current

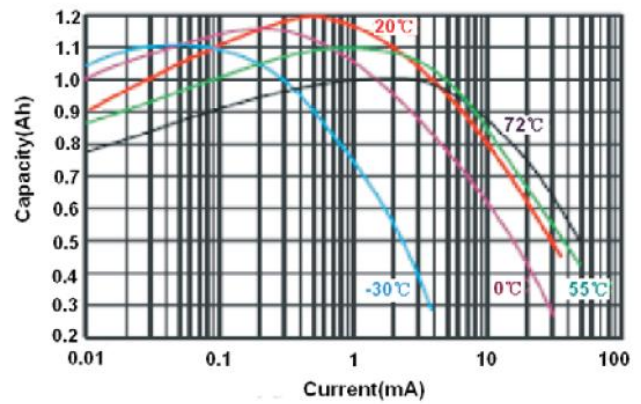

Voltage VS Temperature

