

## G10q LED Circular Tube Datasheet



**Product benefits**

---

- Energy savings of up to 70% (compared to T8 fluorescent lamp on CCG)
- Maximum resistance to switching loads
- Correct operation even at low temperatures
- Instant 100 % light, no warm-up time
- Extremely break resistant thanks to aluminum heat sink and polycarbonate cover

**Product features**

---

- Aluminum base is excellent for heat-sink transfer and more rigid.
- Patented power supply with wide voltage to suit worldwide market with single version tube.
- Input voltage is 85–265VAC.
- Brightness is even more than conventional lamps when use is normal illumination area.
- Characterized by durable, energy saving, environmental protection and soft ray.
- No RF interference. Solid-state, high-shock and vibration resistant.
- Major reduction in power costs, Maintenance free, easy installation.
- Low power consumption, high intensity





## Test Report :

|            |       |         |           |         |          |          |
|------------|-------|---------|-----------|---------|----------|----------|
| x = 0.3089 | 主波长:  | 485.3nm | 显色性指数     | R1 = 73 | R6 = 67  | R11 = 74 |
| y = 0.3216 | 色纯度:  | 9.2%    | Ra = 73.1 | R2 = 75 | R7 = 81  | R12 = 42 |
| u = 0.1980 | 峰值波长: | 447.8nm |           | R3 = 75 | R8 = 65  | R13 = 72 |
| v = 0.3091 | 半宽度:  | 20.0nm  | 光通量       | R4 = 76 | R9 = -16 | R14 = 86 |
| CCT: 6216K | 红色比:  | 13.4%   | 辐射功率      | R5 = 74 | R10 = 39 |          |

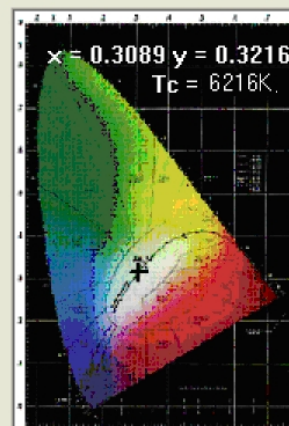
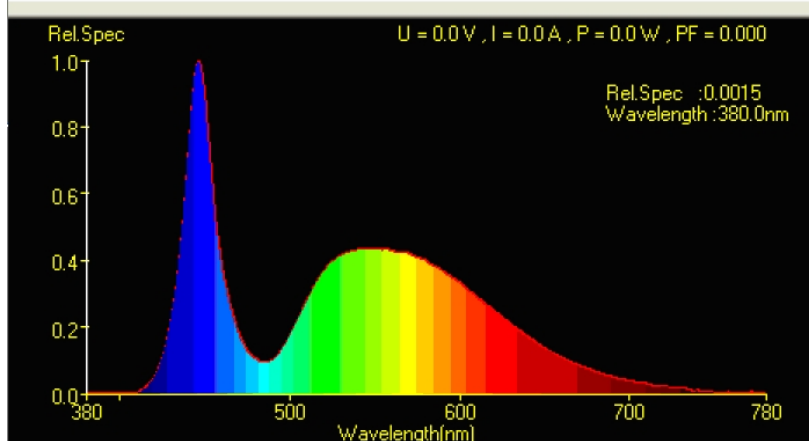

|            |       |         |           |         |          |          |
|------------|-------|---------|-----------|---------|----------|----------|
| x = 0.3089 | 主波长:  | 485.3nm | 显色性指数     | R1 = 73 | R6 = 67  | R11 = 74 |
| y = 0.3216 | 色纯度:  | 9.2%    | Ra = 73.1 | R2 = 75 | R7 = 81  | R12 = 42 |
| u = 0.1980 | 峰值波长: | 447.8nm |           | R3 = 75 | R8 = 65  | R13 = 72 |
| v = 0.3091 | 半宽度:  | 20.0nm  | 光通量       | R4 = 76 | R9 = -16 | R14 = 86 |
| CCT: 6216K | 红色比:  | 13.4%   | 辐射功率      | R5 = 74 | R10 = 39 |          |

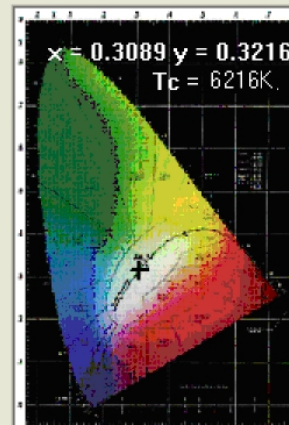
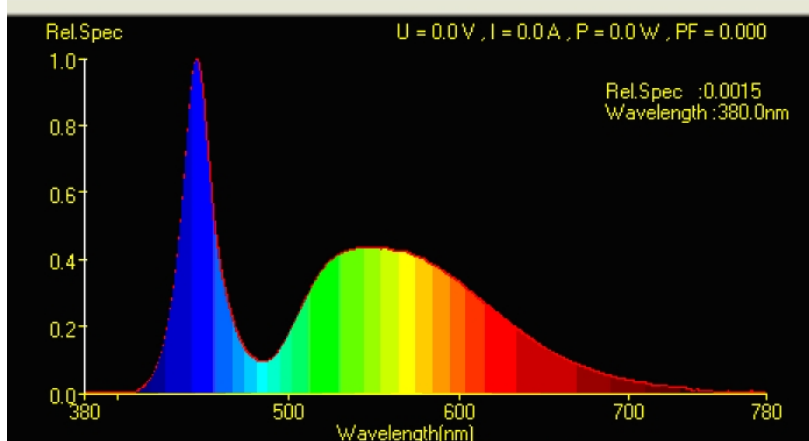

## Product datasheet

**Installation**

---

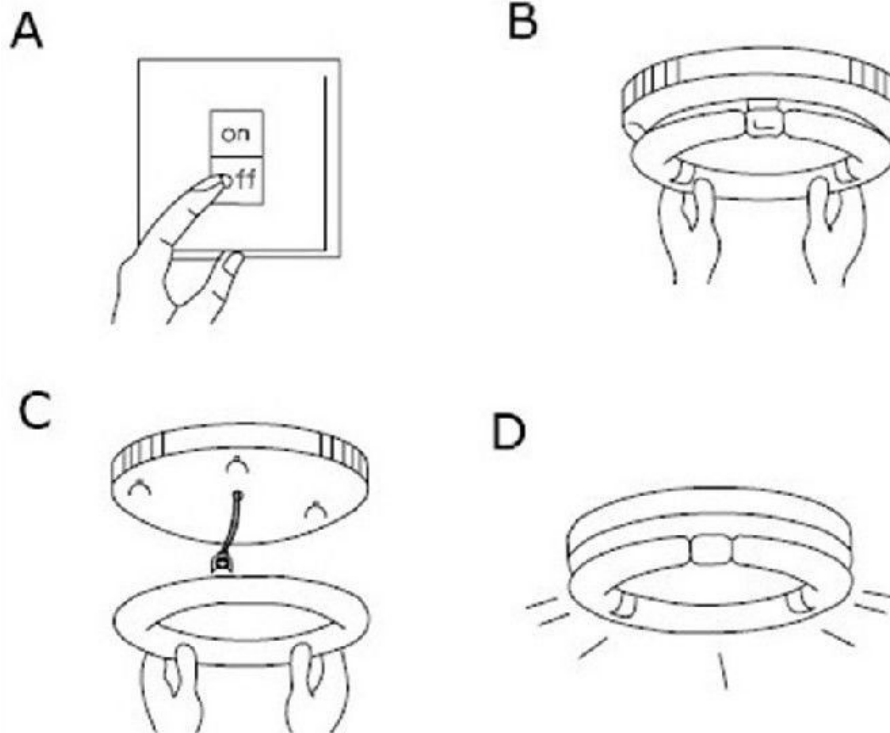
**Packing Info**

---



## References/Links

---

For further products and actual information concerning LED lamps see

[www.hotenda.com](http://www.hotenda.com)

## Disclaimer

---

Subject to change without notice. Errors and omission excepted. Always make sure to use the most recent release.

## Contact Us

---

### **Hotenda Technology Co.,Ltd**

**Marketing Center:** RM1311 JiaHe Edifice B, FuTian District, ShenZhen, CN

Tel: +86 755 - 8379 9939

Fax: +86 755 - 8379 4709

E-mail: [admin@hotenda.com](mailto:admin@hotenda.com)

Skype : key.led

**Factory address:** Building B, Fuzhen Technologies Park, FuYuan 2nd Road, Fu Yong, Bao'an District, Shenzhen, CN

Tel: +86 755 - 8367 7937